

EXPLOSION-PROOF CONNECTION HEAD WITH SPRING-LOADED ASSEMBLY AND MOUNTING HARDWARE

How to build a part number:

To order an Applied Sensor Technologies temperature sensor, select the requirements for the categories listed below and fill in the corresponding boxes with your selection. Don't see exactly what you need? Give us a call!

SENSOR TYPE	ASSEMBLY STYLE	CONNECTION	CONNECTION LENGTH	SHEATH DIAMETER	SHEATH MATERIAL	CALIBRATION	HOT JUNCTION	SHEATH LENGTH	OPTIONS

SENSOR TYPE

MI – Mineral insulated thermocouple

ASSEMBLY STYLE

77 – Sheath with cast aluminum head; spring-loaded in head; CSA/FM approved head for Class I, Division 1, Groups B, C, D; Class II, Groups E, F, G; screw cover with chain and gasketed o-ring; designed for NEMA 4; ceramic terminal block; 1/2" NPT conduit and process connections.

CONNECTION

H – Head only, no mounting hardware; 1/2" NPT (female) instrument connection

N – 1/2" NPT carbon steel nipple

NU – 1/2" NPT carbon steel nipple and plated steel explosion-proof union

NUN – 1/2" NPT carbon steel nipples and plated steel explosion-proof union

Add suffix "**1S**" for 304 stainless steel nipples

CONNECTION LENGTH

(e.g., 006 = 6 inch)

(See chart below for standard available lengths)

SHEATH DIAMETER

4 – 1/8 (0.125)

6 – 3/16 (0.188)

7 – 1/4 (0.250)

9 – 3/8 (0.375)

SHEATH MATERIAL

3 – 316 stainless steel

CALIBRATION - Standard limits

J – Single J

JJ – Dual J

K – Single K

KK – Dual K

T – Single T

TT – Dual T

E – Single E

EE – Dual E

Special limits are available – consult AST

HOT JUNCTION

G – Grounded junction

U – Ungrounded junction

SHEATH LENGTH: (Note: lengths over L84 will be shipped coiled unless otherwise specified at time of order)

L# - (e.g., L6 = 6 inch sheath, L12.5 = 12.5 inch length)

OPTIONS – see back page

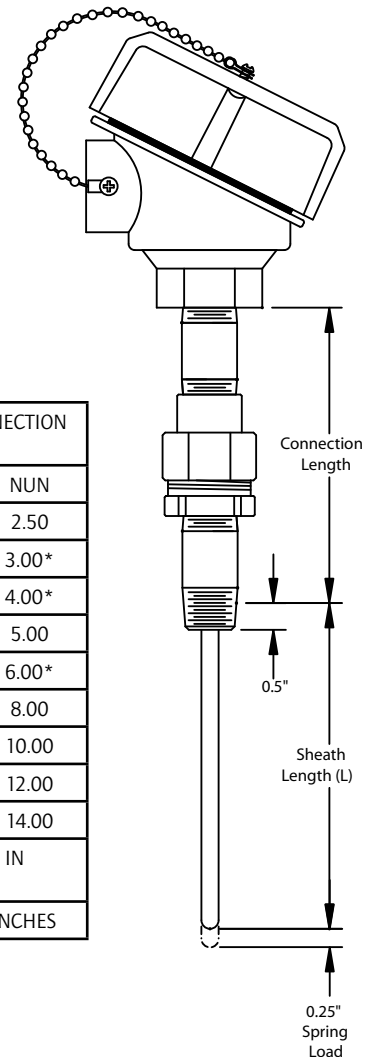

STANDARD AVAILABLE CONNECTION LENGTHS		
N	NU	NUN
N/A	2.00	2.50
0.50	2.50	3.00*
1.00	3.00	4.00*
1.50	3.50	5.00
2.00	4.00	6.00*
3.00	5.00	8.00
4.00	6.00	10.00
5.00	7.00	12.00
6.00	8.00	14.00
*NUN 2S OPTION AVAILABLE IN THESE LENGTHS ONLY.		
DIMENSIONS ARE GIVEN IN INCHES		

STYLE 77

AVAILABLE OPTIONS and MODIFICATIONS

ASSEMBLY OPTIONS	
Option Codes	Description
TAG1	Stainless steel tag and wire
CAL1	NIST traceable calibration [specify point(s)]
CRT1	Certificate of conformance
TRANSMITTERS	
See Style 48 for available transmitters	

EXPLOSION-PROOF TERMINAL HEAD OPTIONS		
Option Code	Process Connection	Conduit Connection
Cast aluminum; screw cover with chain; o-ring gasket; ceramic terminal block; FM/CSA approved for Class I Div. 1, Groups B, C and D; Class II Groups E, F and G (Gasket rated to 100°C exposure); internal ground screw		
HD71	1/2"	3/4"
Same as above, except epoxy-coated		
HD80	1/2"	1/2"
HD81	1/2"	3/4"

Note: See Accessories section for outline drawings and additional specs.

THERMOWELLS & PROTECTION TUBES

For a complete offering of metal, ceramic and composite material thermowells and protection tubes, please see the Thermowell and Protection Tube sections.

EXTENSION WIRE

A selection of extension-grade thermocouple wire is available to connect the sensor to its input device. Consult Accessories section.

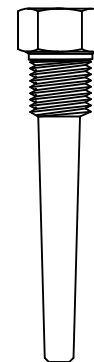

H260
THERMOWELL

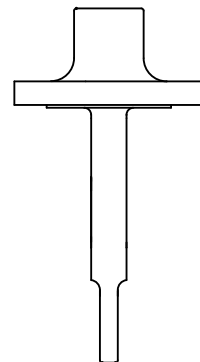

F260
THERMOWELL